

Micrewtube® with Washer Seal Screw Cap

T332

With Washer Seal Screw Cap and Attachment Loop

Made of polypropylene

The washer seal secured in the top of the cap ensures a positive leakproof seal, time after time, keeping the integrity of small samples under even the most adverse conditions. This series of tubes is available either plain or with printed graduations and white marking area for sample identification. Caps are supplied with attachment loops, and allow them to remain attached to the tube in order to prevent mix-up and contamination. These microcentrifuge tubes have all the other fine features stated in the general description. Perfect for cryogenic work. Non skirted tubes can be centrifuged up to 20,000 x g. Skirted tubes can be centrifuged up to 17,000 x g. Will withstand temperatures from -196 °C to +121 °C.

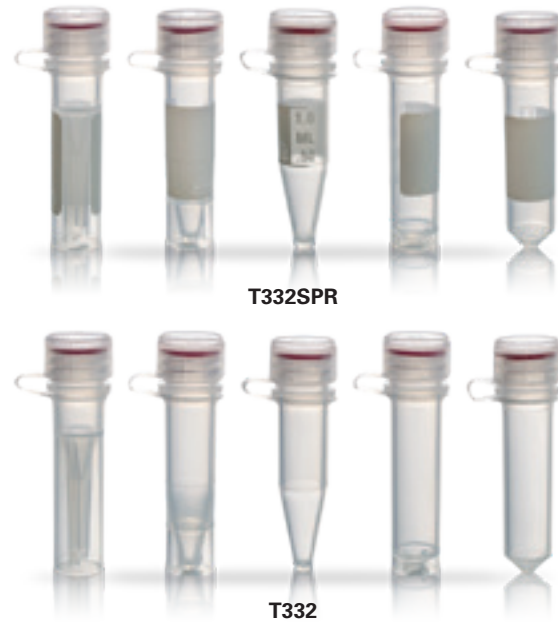
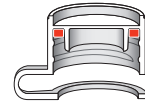

95 kPa
TESTED



Products on this page are certified, RNase, DNase, Pyrogen and DNA-free



1783278379
Barcode printing available. Contact Simport® for more details.

T334

With Washer Seal Screw Cap

Made of polypropylene

Similar to the T332 Series but without the “tethered cap” feature. This series of tubes is available either plain or with printed graduations and white marking area for sample identification. The caps do not have the attachment loops for users who prefer to remove the caps completely from the tubes when filling or sampling. These microcentrifuge tubes have all the other fine features stated in the general description. Perfect for cryogenic work. Non skirted tubes can be centrifuged up to 20,000 x g. Skirted tubes can be centrifuged up to 17,000 x g. Will withstand temperatures from -196 °C to +121 °C.

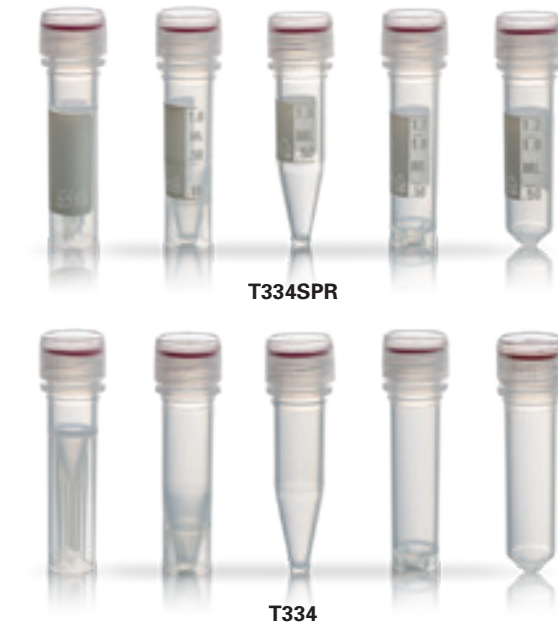

95 kPa
TESTED



Products on this page are certified, RNase, DNase, Pyrogen and DNA-free



1783278379
Barcode printing available. Contact Simport® for more details.

T335

With Washer Seal and Flat Top Screw Cap

Made of polypropylene

This series of tubes is also available either plain or with printed graduations and white marking area for sample identification. These flat surfaced caps can be used with automatic capping machines in packaging industries. Closures are supplied in natural color. Perfect for cryogenic work. Non skirted tubes can be centrifuged up to 20,000 x g. Skirted tubes can be centrifuged up to 17,000 x g. Will withstand temperatures from -196 °C to +121 °C.



95 kPa
TESTED



Products on this page are certified, RNase, DNase, Pyrogen and DNA-free



1783278379
Barcode printing available. Contact Simport® for more details.

Micrewtube® with Lip Seal Screw Cap

T336

With Lip Seal Screw Cap and Attachment Loop

Made of polypropylene, Cap made of polyethylene

The flexible sealing lip inside the cap ensures a positive leakproof seal under even the most adverse conditions. This deep internal lip fits snugly against the interior wall of the tube preventing the contents from coming in contact with the threads, thus reducing the chances of sample contamination. This series of tubes is available either plain or with printed graduations and white marking area for sample identification. Caps are supplied with attachment loops in order to prevent contamination and mix-up. These microcentrifuge tubes have all the other fine features stated in the introduction page, but cannot be autoclaved since closure is made of high density polyethylene. Non skirted tubes can be centrifuged up to 20,000 x g. Skirted tubes can be centrifuged up to 17,000 x g. Will withstand temperatures from -196 °C to +110 °C.

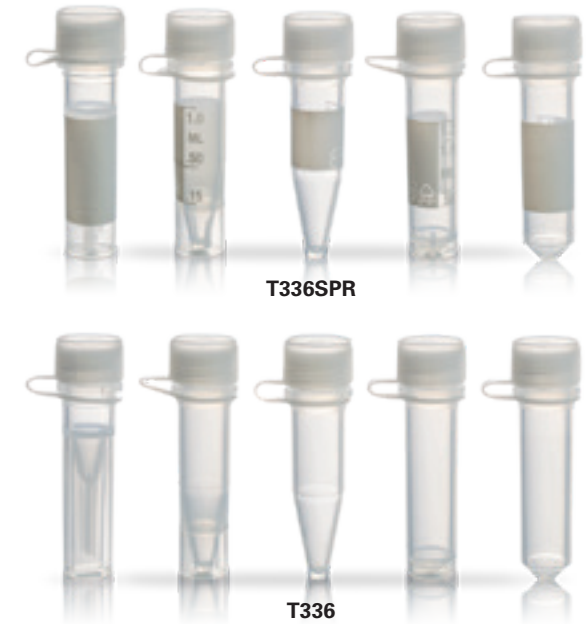
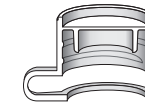

95 kPa
TESTED



Products on this page are certified, RNase, DNase, Pyrogen and DNA-free



1783278379
Barcode printing available. Contact Simport® for more details.

T338

With Lip Seal Screw Cap

Made of polypropylene, Cap made of polyethylene

Similar to the T336 Series but without the “tethered cap” feature. This series of tubes is available either plain or with printed graduations and white marking area for sample identification. They have all the other fine features of the T336 series of tubes, but the caps are not supplied with the attachment loop for users who prefer to remove the caps completely from the tubes when filling or sampling. Cannot be autoclaved since closure is made of high density polyethylene. Non skirted tubes can be centrifuged up to 20,000 x g. Skirted tubes can be centrifuged up to 17,000 x g. Will withstand temperatures from -196 °C to +110 °C.



95 kPa
TESTED



Products on this page are certified, RNase, DNase, Pyrogen and DNA-free



1783278379
Barcode printing available. Contact Simport® for more details.

T339

With Lip Seal and Flat Top Screw Cap

Made of polypropylene, Cap made of polyethylene

This series of tubes is available either plain or with printed graduations and white marking area for sample identification. These flat surfaced tubes can also be used with automatic capping machines and in packaging industries. Closures are supplied in natural color. Tubes are made of polypropylene while polyethylene caps are easy to screw on and off. More economical than T335 Series O-ring seal model. Cannot be autoclaved since closure is made of high density polyethylene. Non skirted tubes can be centrifuged up to 20,000 x g. Skirted tubes can be centrifuged up to 17,000 x g.

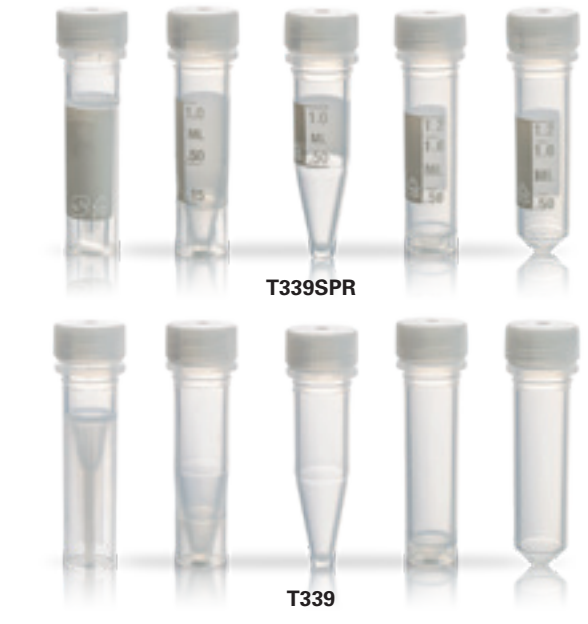
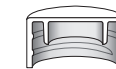

95 kPa
TESTED



Products on this page are certified, RNase, DNase, Pyrogen and DNA-free



1783278379
Barcode printing available. Contact Simport® for more details.

